



## **RF-726**

### **RFID MIFARE-1 LOCK**

The RF-726 is a small RFID lock, suitable for public and private use with up to 100 cards capable of opening each lock. The RF-726 can also be used for left or right-hand positions, making it highly versatile for end users.



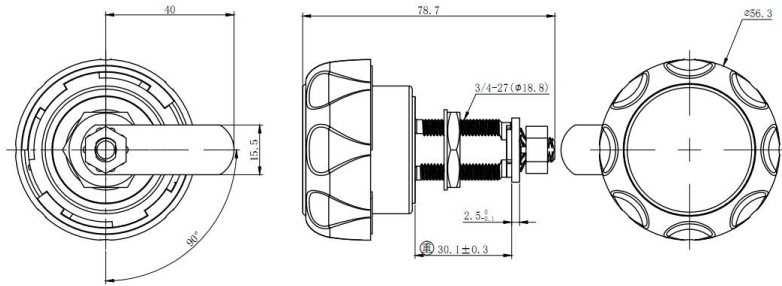

## PRODUCT INFORMATION

### FEATURES

- RFID card functionality
- Internal battery (externally accessible)
- 3-level management: Main admin, admin, and user
- Main admin and admin RDIF cards available to purchase
- Users RFID cards available to purchase
- Can be set up to have multiple RFID cards capable of accessing the locker
- LED in-use indicator
- Can be used for the left or right handle
- Can be used for public and private use
- 1-year product warranty

### LOCKER COMPATIBILITY

	COMPATIBLE	NOT COMPATIBLE
Laminate Locker	•	
ABS Plastic Locker		•
HD Plastic Locker	•	
HD Waterproof Locker		•
Carousel Locker		•
Mobile Phone Locker		•
Laptop Locker		•
HD School Locker		•
Steel Locker	•	

### TECHNICAL SPECIFICATONS

LOCK CODE	LOCK NAME
LKMK 0726RF	RF-726 RFID Mifare-1 Lock